

# miniSATA User Manual

## Package Content

No	P/N	Description	Q'ty	Picture
1	5XQT-118-A	miniSATA hand jig	1	
2	5R19A02-A	HDMI 19M A type/SATA*3 Adapter	2	
3	5R19A03-A	HDMI 19M C type / SATA*3 Adapter	Optional	
4	5R20A03-A	Display Port 20M/ SATA*3 Adapter	Optional	
5	5R20A04-A	Mini Display Port 20M/ SATA*3 Adapter	Optional	
6	5R07A05-A	USB 2.0 4Male/SATA Adapter	2	
7	5R07A06-A	USB 2.0 4 Female/SATA Adapter	2	
8	5R07A03	eSATA7F/SATA7M Adapter	2	
9	5MIS07F-30	Body of miniSATA IDC	30	
10		Front Cover of miniSATA IDC	30	
11		Latch of miniSATA IDC	30	
12	5XQT-121-A	miniSATA / RJ45 / USB Multi-Modular Cable Tester	1	
13	5C08A41-X019	RJ45-SATA 7 Male Tested Cable	2	
14	6CFY-08A-M20	MiniSATA Raw Cable	10M * 2	
15	5XQT-085-C	User Manual	1	
16	5XPL-170-CASE	Portable Protect Case	1	

## Application

Tip : How to adapt other interfaces with miniSATA cable

Adapter (Left) - (Right)	Cable connected to... (Left) - (Right)
USB – USB	J1 - J1
eSATA – eSATA	J1 - J1
HDMI – HDMI	J1 - J1 / J2 - J2 / J3 - J3
DP – DP	J1 - J2 / J2 - J1 / J3 - J3

Tip : Recommend cable length

Interface	Specification	Length
HDMI & Display Port	1080i	Up to 4.0M
	1080P	Up to 2.5M
USB2.0	480Mbps/Sec.	Up to 4.5M*
e-SATA	3Gbps/Sec. (SATA 2)	Up to 1.5M
SATA	3Gbps/Sec. (SATA 2)	Up to 1.0M

\*Due to 2.5" External HDD consumes more power than USB port might supply, auxiliary power is needed while cable is longer than 1M.

**Caution :** (1) Use miniSATA cable only for above adapting methods otherwise electric devices such as monitor, TV or BD player might be burned.  
 (2) Except for SATA and eSATA, DO NOT connect with different interfaces with one miniSATA cable, otherwise PC or driver might be burned.

## Cable Assembly Process

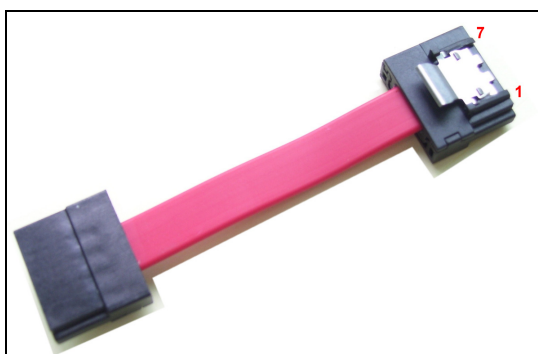

- Step1** Set connector body into interior groove of hand jig.
- Step2** Assemble cable and front cover front cover.
- Step3** Set cable with front cover above connector body.
- Step4** Clasp handles of both sides to the limit to assemble.
- Step5** Take out assembled cable.
- Step6** Insert latch along the trench on connector.
- Step7** Set connector with latch in the exterior groove of hand jig.
- Step8** Clasp handles of both sides to the limit.
- Step9** Plug the two RJ45-SATA 7 Male Tested Cables to the top RJ45 socket and the left one. Connect a tested miniSATA cable with the two tooling cables.
- Step10** Turn the power switch to "TEST". With each press to the "TEST" button, LEDs of the upper and lower rows will light up in sequence from 1 to 7. If they do, then the test is completed.

Tip : For video of operating details, please visit the following site <http://www.youtube.com/watch?v=jP6wUA6hNtk>

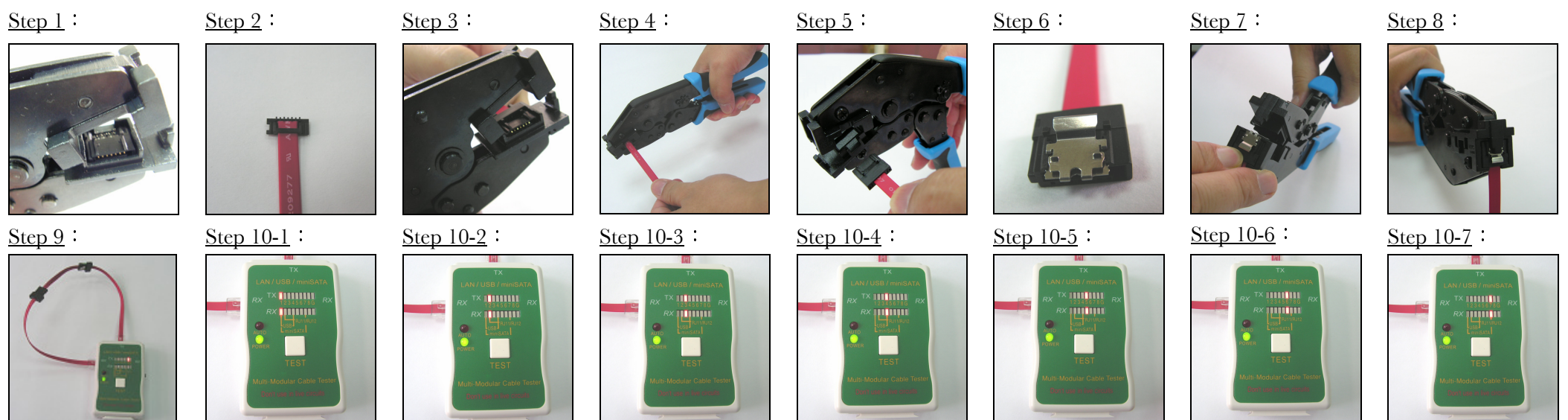

**NG and Fix** If you read out the incorrect LED display as Form A, the tested cable is short, open, reversed, miss-wired, or crossed.

**SHORT** : 3 Leds of the upper and lower row light up at the same time.

**OPEN** : While press the "TEST" button, LEDs of the upper and lower row do not light up at the same time.

**REVERSE** : The LEDs of the lower row light up in a reversed order.

Note: If the battery is low on power, the LEDs will be dimmed or no lit light, and the test result will be incorrect.

**How to fix** : If the test result is NG, just cut the connector and repeat above steps to assemble.